

Green Roof System — GR52

TECHNICAL DATA SHEET

STORM WATER MANAGEMENT SOLUTIONS

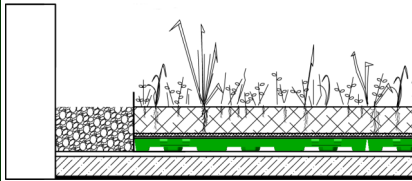

SAMPLE GREEN ROOF DETAIL

WATER FLOWS THROUGHOUT THE ENTIRE PANEL VIA RESERVOIR CUPS AND CHANNELS TO ASSURE UNIFORM DISTRIBUTION

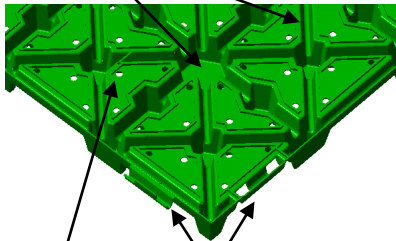

WATER OVERFLOW DRAINAGE HOLES

LOCKING SYSTEM PANELS SNAP TOGETHER

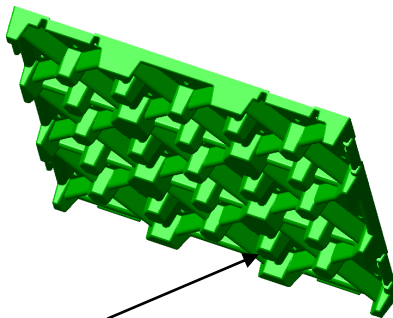

ROUNDED EDGES ON BOTTOM OF WATER RESERVOIRS TO PREVENT ROOF DAMAGE

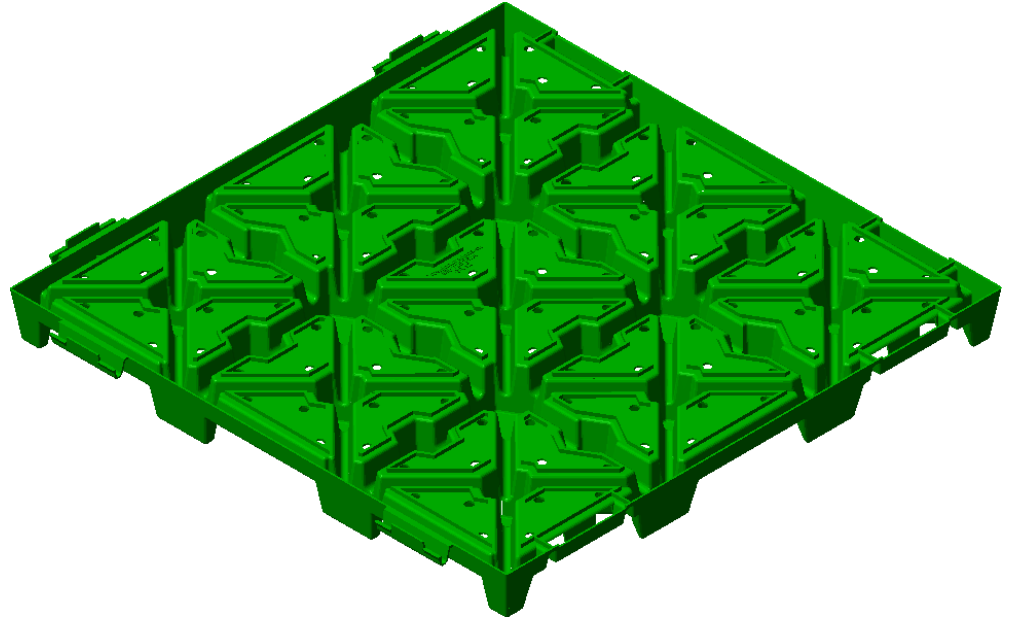

The GR52 green roof panel is designed as a water retention and drainage component suitable for intensive and extensive green roof design.

SPECIFICATIONS

SIZE

24" x 24" x 2 1/8"

4 sq. ft / .372m²

WEIGHT DRY

3.42 lbs. per panel

0.86 lbs. per sq. ft / 4.17kg./m²

WEIGHT INCL. WATER WATER CAPACITY

3.79 lbs. per sq. foot / 18.52kg./m²

0.352 US Gallons per sq. foot

14.35 L/m²

MATERIAL

100% Recycled HDPP (color black - shade may vary)

Notched Izod Impact ASTM D256

Flexural Modulus ASTM D790

WORKING TEMP

minus 40 °F to 212 °F

LEED CREDITS

- SS Credit 6 - Stormwater Management
- SS Credit 7 - Landscape & Exterior Design To Reduce Heat Islands
- MR Credit 4 - Recycled Content

ISO 9001.2008



green innovations

3700 SALEM RD.
PICKERING, ONT L1Y 1E8
888-725-7524
greenroofs.us

